

# Floor Plans

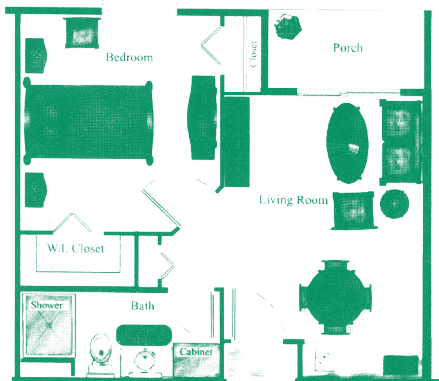

*Evergreen*

Living Room ..... 11' 8" x 16'    543 sq. ft. Total  
 Bedroom..... 11' 8" x 13'    Garden Apartment

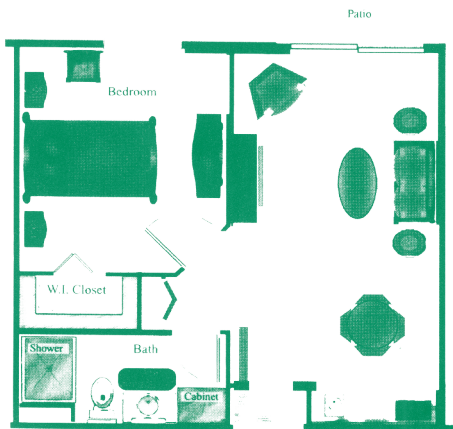

*Evergreen II*

Living Room ..... 11' 8" x 21' 7"    588 sq. ft. Total  
 Bedroom..... 11' 8" x 10'    Garden Apartment

# Floor Plans

## Spruce

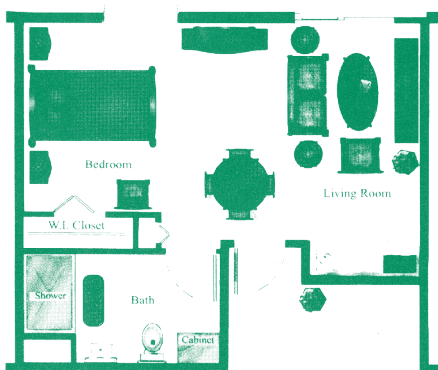

476 sq. ft. Total  
Studio Apartment

Suite ..... 14' x 23' 6"

## Pine Cone

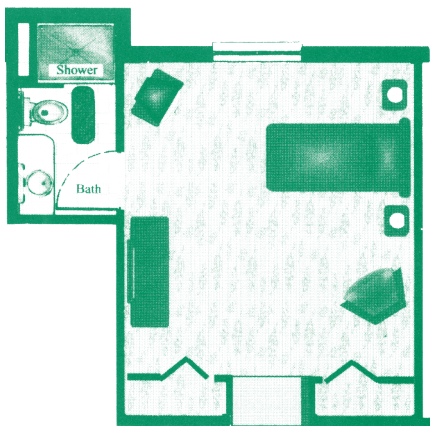

339 sq. ft. Total  
Studio Apartment

Suite ..... 14' x 16' 4"



*North Port Pines Retirement Residence*  
4950 Pocatella Avenue • North Port, Florida 34287  
Tel: 941.423.0658 • Fax: 941.423.2663  
Assisted Living #7860